

Ran[®] 1/2" (12.7 mm)

316 Stainless Steel Body

Diaphragm Pump



Technical Specifications

| | |
|---------------------------------|----------------------|
| Pump Code | B15-SC0-2 |
| Max. Flow Rate | 70 lpm |
| Max. Pump Speed | 400 cpm |
| Displacement per cycle | 0.18 liter |
| Fluid Inlet- Outlet Size | 1/2" NPT |
| Air Inlet Size | 1/4" |
| Max. Fluid Working Pressure | 8 bar |
| Max. Air Consumption (at 5 bar) | 24 m ³ /h |
| Ratio | 1:1 |

| | |
|----------------------------|-------------------------|
| Pump Housing Material | 316 Stainless Steel |
| Center Section Material | Polypropylene |
| Max. Size Pumpable Solids | 2 mm |
| Max. Suction Lift | 7.5 m (Wet) 3.5 m (Dry) |
| Max. Operating Temperature | 82 °C |
| Sound Level | 65 dBa (at 5 bar) |
| Diaphragm Material | Buna-N |
| Check-Valve Material | Buna-N |
| Weight | 7 kg |

Performance Curves

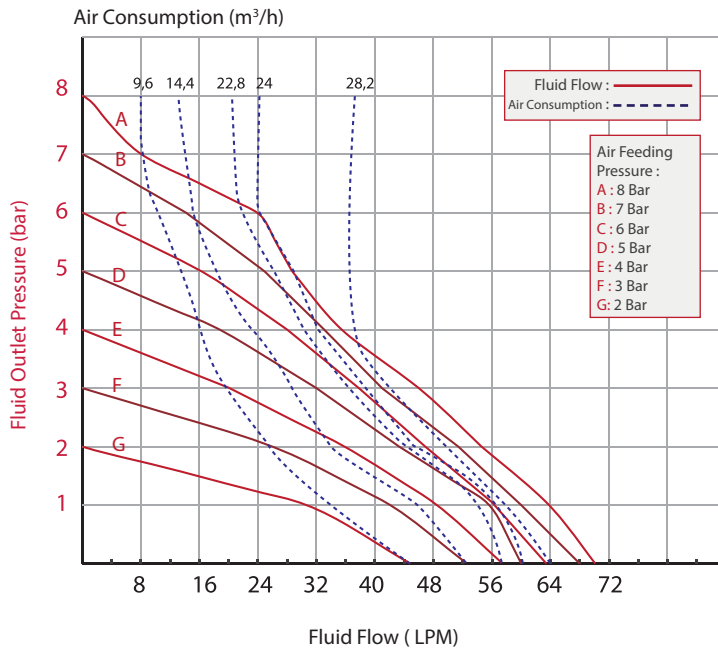

Made in Turkey



Test Conditions: All tests are made with water. Suction hose submerged in the fluid. Muffler not used. All the values are shown are approximate and not binding.

Example: To pump 45 lpm against a discharge pressure of 2.7 bar, requires 7 bar and 28.2 m³/h air consumption.

Dimensions

| | |
|---|-----|
| A | 194 |
| B | 274 |
| C | 150 |
| D | 220 |
| E | 32 |
| F | 152 |
| G | 100 |
| H | 9 |

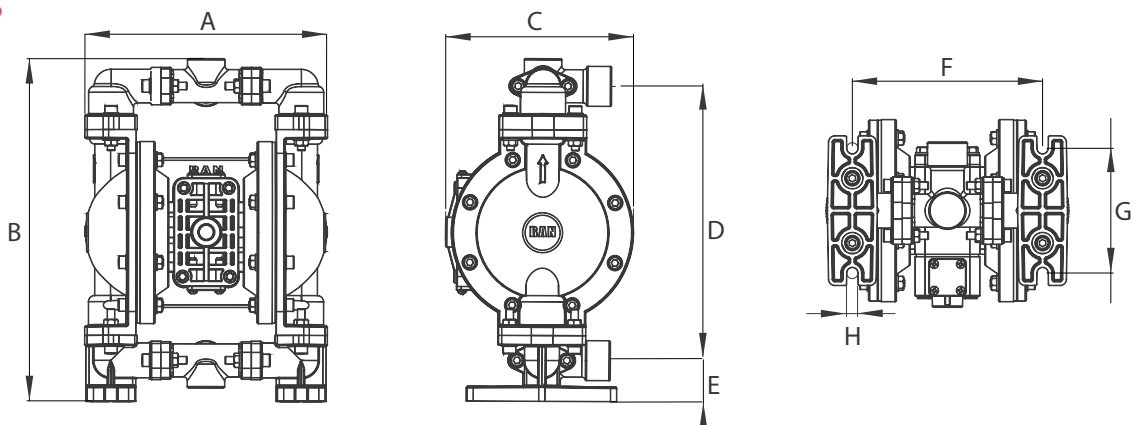

All dimensions are in mm.